

This page has been intentionally left blank.

Heat Risers





Heat Risers

14001	14001
OEM # 3225005	
	
A. N/A R. HR005	M. HR820 W. N/A

14002	14002
OEM # 3225006	
	
A. N/A R. HR403	M. HR006 W. N/A

14007	14007
OEM # 3111465	
	
A. N/A R. HR401	M. HR465 W. N/A

14027	14027
OEM # E1SZ-9A427A	
W/Vacuum	
	
A. N/A R. HR815	M. HR427A W. N/A

14033	14033
W/Vacuum	
	
A. N/A R. HR817	M. HR427B W. N/A

14003	14003
OEM # 3887023	
Uses Gasket: 13083	
	
A. 9885 R. HR100	M. HR023 W. N/A

14004	14004
OEM # 3887024	
Uses Gasket: 13083	
	
A. 9886 R. HR101	M. HR024 W. N/A

14005	14005
OEM # 3887034	
Uses Gasket: 13011	
	
A. N/A R. HR102	M. HR034 W. N/A

14009	
OEM # 3969903	
	
A. N/A R. HR103	M. HR903 W. N/A

14010	
OEM # 355915 - 5234825	
Uses Gasket: 13020	
	
A. N/A R. HR105	M. HR915 W. N/A

A. AP/GOERLICH'S; M. MARWIL; R. ROL; W. WALKER

Heat Risers

14021 **14021**
OEM # 5233150 **W/Vacuum**



A. N/A M. HR150
 R. HR802 W. N/A

14022 **14022**
OEM # 5233155 **W/Vacuum**



A. N/A M. HR155
 R. HR805 W. N/A

14023 **14023**
OEM # 5233320 **W/Vacuum**



A. N/A M. HR320
 R. HR801 W. N/A

14024 **14024**
OEM # 5233475 **W/Vacuum**



A. N/A M. HR475
 R. HR803 W. N/A

14026 **14026**
OEM # 5233650 **W/Vacuum**



A. N/A M. HR650
 R. HR809 W. N/A

14030 **14030**
OEM # 5233200



A. N/A M. HR200
 R. HR200 W. N/A

14031 **14031**
Uses Gasket: 13083



A. N/A M. HR024B
 R. HR151 W. N/A

14032 **14032**
Uses Gasket: 13011



A. N/A M. HR034B
 R. HR152 W. N/A

14011 **14011**
OEM # 324888C92



A. N/A M. HR92
 R. HR501 W. N/A

A. AP/GOERLICH'S; M. MARWIL; R. ROL; W. WALKER

This page has been intentionally left blank.

EXHAUST MANIFOLD CLAMP-A-STUD

**IF YOU'RE LUCKY
THIS JOB WILL TAKE
HALF AN HOUR**



**THE
CLAMP-A-STUD
IS NOT A
TEMPORARY
CLAMP!
IT'S MADE OF
FORGED
STEEL**

**IF YOU'RE SMART, IT
WILL TAKE TEN
MINUTES**

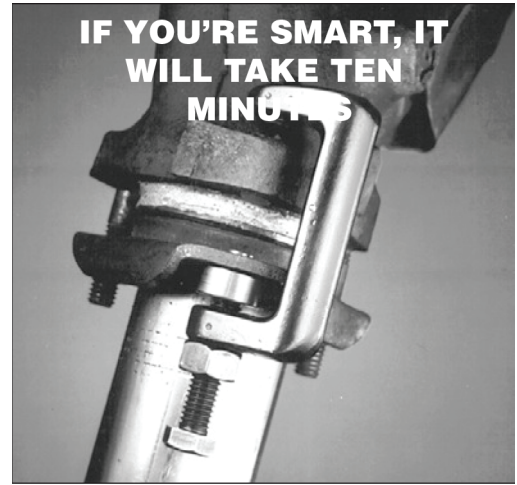

Go ahead. Ask anybody. A broken manifold stud is the worst job under a car to repair. Nickson makes that job easy!

Nickson's Clamp-A-Stud is the permanent solution to broken or impossible to get at manifold studs. Made of rugged, forged alloy steel, the Clamp-A-Stud is not for temporary use. It's a permanent, durable, professional alternative to conventional manifold repair. It takes ten minutes to install and even works on some manifolds with cracked or broken tangs. This ingenious new product has been field tested with outstanding success. No welding, drilling, or tapping is required.

For part Number listing see Page 175

Specialty Products

CLAMP A STUD

ni Number	Item Number	Size	R.	M.	Qty.
17350	17350	1/4" - 1-3/4"	N/A	N/A	10
17351	17351	1-1/4" - 2-3/4"	N/A	N/A	10
17352	17352	2-1/4" - 3-3/4"	N/A	N/A	10



17350
17351
17352

MUFFLER CEMENT

ni Number	Item Number	Size	R.	M.	Qty.
42016	14201	16oz	CEM016	MCS	1
42006	14202	6oz	CEM006	MCD	1

42016
16oz



42006
6oz

PIPE HOOKS

ni Number	Item Number	Size	R.	M.	Qty.
54397	54397	Pipe Size Under 3"	FW231	TPH231B	50
54398	54398	Pipe Size 3"	FW242	TPH242B	50



Under 3" Pipe

54397



3" Pipe

54398

A. AP/GOERLICH'S; M. MARWIL; R. ROL; W. WALKER

Metric Manifold Stud & Nut Bin - ni Number 56001

Compartment 1			Compartment 2			Compartment 3		
ni Number	Qty.	Notes	ni Number	Qty.	Notes	ni Number	Qty.	Notes
12153	100		12154	50		12156	50	
8mm x 1.25P Nut			10mm x 1.25P Nut			10mm x 1.50P Nut		

Compartment 4			Compartment 5			Compartment 6		
ni Number	Qty.	Notes	ni Number	Qty.	Notes	ni Number	Qty.	Notes
12154	50		12159	50		12353	50	
10mm x 1.25P Nut			12mm x 1.50P Nut			Nissan, VW, Stud		

Compartment 7		
ni Number	Qty.	Notes
12356	25	
Honda, VW, Stud		

Compartment 8		
ni Number	Qty.	Notes
12359	25	
Pinto, Capri, Volvo, Stud		

Compartment 9		
ni Number	Qty.	Notes
12356	25	
Honda, VW, Stud		

Compartment 10		
ni Number	Qty.	Notes
12358	25	
Universal Stud		



56001

Hardware Assortments

Hardware Assortment Bin - ni Number 56002

HARDWARE BIN CONTENTS		
ni Number	Qty.	Description
12006	50	3/8 x 1 Hex Bolt, Course (USS-UNC)
12007	50	3/8 x 1-1/2 Hex Bolt, Course (USS-UNC)
12017	50	3/8 x 1-1/4 Hex Bolt, Course (USS-UNC)
12009	50	3/8 x 2-1/2 Hex Bolt, Course (USS-UNC)
12010	50	3/8 x 3 Hex Bolt, Course (USS-UNC)
12002	50	5/16 x 1 Hex Bolt, Course (USS-UNC)
12003	50	5/16 x 1-1/2 Hex Bolt, Course (USS-UNC)
12300	50	3/8 x 2 Manifold Stud, Course (USS-UNC)
12301	10	3/8 x 2-1/2 Manifold Stud, Course (USS-UNC) W/Finder
12302	50	3/8 x 3-1/2 Manifold Stud, Course (USS-UNC) W/Finder
12303	10	7/16 x 2 Manifold Stud, Course (USS-UNC)
12305	10	7/16 x 4 Manifold Stud, Course (USS-UNC)
12103	50	3/8 Std Hex Nut, Course (USS-UNC)
12101	50	5/16 Std Hex Nut, Course (USS-UNC)
12074	50	5/16" x 7/16" High Style Flange Nut
12107	50	7/16 x 5/8 Std Hex Nut, Course (USS-UNC)
12053	50	8mm x 25mm, 1.25 Pitch, Hex Bolt
12057	50	10mm x 50mm, 1.5 Pitch, Hex Bolt
12051	25	6mm x 50mm, 1.00 Pitch, Hex Bolt
12353	20	8mm x 40mm, 1.25 Pitch, Manifold Stud
12561	20	8mm x 70mm, 1.25 Pitch, Shoulder Bolt
12385	50	10mm x 1.50P x 52mm Manifold Stud
12356	20	10mm x 42mm, 1.25 Pitch, Manifold Stud
12562	25	10mm x 70mm, 1.5 Pitch, Shoulder Bolt
12358	10	12mm x 50mm, 1.25 Pitch, Manifold Stud
12153	50	8mm, 1.25 Pitch, Std Hex Nut
12154	25	10mm, 1.25 Pitch, Std Hex Nut
12156	50	10mm, 1.5 Pitch, Std Hex Nut
12158	25	12mm, 1.25 Pitch, Std Hex Nut
12205	50	3/8 x 1-1/2 Hex Sheet Metal Screw
12201	50	5/16 x 1 Hex Sheet Metal Screw



56002 - With contents
561006 - Empty Hardware Bin

HEXAGON BOLTS

ni Number	Size	Thread Type	Grade	Thread Length	R.	M.	Qty.
12041	1/4 x 3/4	Coarse	2	Full	H298	CS298	100
12043	1/4 x 3/4	Coarse	5	Full	H110	CS110	100
12042	1/4 x 1	Coarse	2	Full	H299	CS140X100	100
12034	1/4 x 1-1/2	Coarse	5	Standard	H112	CS112	100
12023	1/4 x 1-1/2	Coarse	2	Standard	H300	CS140X112	100
12019	1/4 x 2	Coarse	2	Standard	H324	CS324	100
12021	1/4 x 3	Coarse	2	Standard	H384	CS384	100
12001	5/16 x 3/4	Coarse	2	Full	H302	CS516X034	100
12121	5/16 x 3/4	Coarse	5	Standard	H113	CS516X034GR5	100
12002	5/16 x 1	Coarse	2	Full	H146	CS516X100	100
12100	5/16 x 1	Coarse	5	Full	H114	CS114	100
12115	5/16 x 1-1/4	Coarse	2	Standard	H147	CS516X114	100
12018	5/16 x 1-1/4	Coarse	2	Full	N/A	N/A	100
12045	5/16 x 1-1/4	Coarse	5	Full	H115	CS115	100
12003	5/16 x 1-1/2	Coarse	2	Full	H237	CS516X112	100
12114	5/16 x 1-1/2	Coarse	2	Standard	H148	CS148	100
12116	5/16 x 1-1/2	Coarse	5	Standard	H116	CS516X112GR5	100
12022	5/16 x 1-3/4	Coarse	2	Standard	H309	CS516X134	100
12117	5/16 x 2	Coarse	2	Standard	H285	CS285	100
12004	5/16 x 2	Coarse	2	Full	H240	CS516X200	100
12035	5/16 x 2	Coarse	5	Standard	H117	CS516X200GR5	100
12005	5/16 x 2-1/2	Coarse	2	Standard	H310	CS516X212	100
12172	5/16 x 2-1/2	Coarse	5	Standard	H311	CS516X212GR5	100
12024	5/16 x 3	Coarse	2	Standard	H222	CS222	50
12308	5/16 x 3	Coarse	2	Full	H249	CS516X300	50
12025	5/16 x 3-1/2	Coarse	2	Standard	H386	CS386	50
12026	5/16 x 4	Coarse	2	Standard	H418	CS516X400	50
12006	3/8 x 1	Coarse	2	Full	H149	CS380X100	100
12046	3/8 x 1	Coarse	5	Full	H118	CS118	100
12118	3/8 x 1-1/4	Coarse	2	Standard	H150	CS380X114	100
12017	3/8 x 1-1/4	Coarse	2	Full	N/A	N/A	100
12170	3/8 x 1-1/4	Coarse	5	Standard	H119	CS380X114GR5	100
12328	3/8 x 1-1/2	Coarse	2	Standard	H151	CS151	100
12007	3/8 x 1-1/2	Coarse	5	Standard	H120	CS380X112GR5	100
12020	3/8 x 1-1/2	Coarse	2	Full	H246	CS380X112	100
12027	3/8 x 1-3/4	Coarse	2	Standard	H301	CS380X134	100
12119	3/8 x 2	Coarse	2	Standard	H152	CS152	50
12036	3/8 x 2	Coarse	5	Standard	H121	CS380X200GR5	50
12008	3/8 x 2	Coarse	2	Full	H234	CS380X200	100
12064	3/8 x 2-1/4	Coarse	2	Full	H235	CS380X214	50
12122	3/8 x 2-1/4	Coarse	2	Standard	H307	CS307	50
12082	3/8 x 2-1/4	Coarse	5	Standard	H399	CS380X214GR5	50
12125	3/8 x 2-1/2	Coarse	2	Standard	H153	CS380X212050	50
12009	3/8 x 2-1/2	Coarse	2	Full	H205	CS380X212	50
12010	3/8 x 3	Coarse	2	Full	H247	CS380X300	50
12120	3/8 x 3	Coarse	2	Standard	H308	CS308	50
12011	3/8 x 3-1/2	Coarse	2	Standard	H154	CS380X312	50
12028	3/8 x 4	Coarse	2	Standard	H325	CS325	25

R. ROL; M. MARWIL

www.nickson.com

**DESIGN MAKES
THE DIFFERENCE**

HEXAGON BOLTS - (Continued)

ni Number	Size	Thread Type	Grade	Thread Length	R.	M.	Qty.
12012	7/16 x 1	Coarse	2	Full	H155	CS716X100	50
12047	7/16 x 1	Coarse	5	Full	H125	CS125	50
12013	7/16 x 1-1/2	Coarse	2	Full	H156	CS716X112	50
12037	7/16 x 1-1/2	Coarse	5	Standard	H126	CS126	50
12014	7/16 x 1-3/4	Coarse	2	Full	N/A	N/A	100
12015	7/16 x 2	Coarse	2	Standard	H157	CS716X200	50
12038	7/16 x 2	Coarse	5	Standard	H127	CS127	50
12029	7/16 x 2-1/2	Coarse	2	Standard	H228	CS716X212	50
12039	7/16 x 2-1/2	Coarse	5	Standard	H313	CS313	50
12063	7/16 x 3	Coarse	2	Standard	H327	CS716X300	25
12040	1/2 x 2	Coarse	5	Standard	H338	CS120X200GR5	25

METRIC HEXAGON BOLTS

ni Number	Size	Thread Pitch	Grade	Thread Length	R.	M.	Qty.
12062	6mm x 15mm	1.00P	2	Full	H226	CS6X20	100
12060	6mm x 18mm	1.00P	2	Full	H200	CS6X12	100
12083	6mm x 30mm	1.00P	2	Full	N/A	CS6X30	100
12048	6mm x 43mm	1.25P	2	Full	H225	CS225	100
12049	8mm x 16mm	1.25P	2	Full	H224	CS224	100
12050	8mm x 20mm	1.25P	2	Full	H250	CS8X20	100
12053	8mm x 25mm	1.25P	2	Full	H229	CS8X25	100
12054	8mm x 30mm	1.25P	2	Full	N/A	N/A	100
12055	8mm x 40mm	1.25P	2	Full	H283	CS8X40	100
12030	8mm x 75mm	1.25P	2	Standard	H398	CS8X76	100
12051	10mm x 20mm	1.25P	2	Full	H337	CS337	100
12065	10mm x 20mm	1.50P	2	Full	H352	CS10X20C	100
12066	10mm x 25mm	1.00P	2	Full	H350	CS10X25	100
12067	10mm x 25mm	1.25P	2	Full	H349	CS10X30F	100
12068	10mm x 25mm	1.50P	2	Full	H340	CS340	100
12069	10mm x 30mm	1.25P	2	Full	H354	CS10X30	100
12056	10mm x 35mm	1.25P	2	Full	N/A	N/A	100
12070	10mm x 40mm	1.50P	2	Full	H353	CS10X40	100
12031	10mm x 50mm	1.25P	2	Standard	H421	CS10X40F	100
12057	10mm x 50mm	1.50P	2	Standard	H387	CS387	50
12032	10mm x 70mm	1.25P	2	Standard	H547	CS547	10
12033	10mm x 75mm	1.25P	2	Standard	H510	CS10X76	50



R. ROL; M. MARWIL

HEXAGON NUTS

ni Number	Size	Thread Type	Style	Description	R.	M.	Qty.
12072	1/4"	Coarse	STANDARD		H100	HN140C	100
12123	1/4"	Fine	STANDARD		H105	HN140F	100
12101	5/16"	Coarse	STANDARD		H101	HN516C	100
12111	5/16"	Coarse	FLANGE	SERRATED	H201	FN516S	100
12102	5/16"	Fine	STANDARD		H106	HN516F	100
12074	5/16" x 7/16"	Coarse	FLANGE		H198	FN516H	100
12124	5/16" x 9/16"	Coarse	SPECIAL	USES 9/16" WRENCH	H203	HN203	100
12103	3/8"	Coarse	STANDARD		H102	HN380C	100
12113	3/8"	Coarse	FLANGE		H202	FN380	100
12106	3/8"	Coarse	FLANGE	SERRATED	H367	FN380S	100
12104	3/8"	Fine	STANDARD		H107	HN380F	100
12107	7/16"	Coarse	STANDARD	USES 11/16" WRENCH	H103	HN716C	50
12108	7/16"	Fine	STANDARD	USES 11/16" WRENCH	H108	HN716F	50
12207	7/16" x 5/8"	Coarse	SPECIAL	USES 5/8" WRENCH	H204	HN716X580	100
12110	1/2"	Coarse	STANDARD		H104	HN120C	50
12073	1"	Coarse	STANDARD		H415	HN415	50



METRIC HEXAGON NUTS

ni Number	Size	Thread Pitch	Style	Application	R.	M.	Qty.
12061	6mm	1.00P	STANDARD		H206	NT6X100MT	100
12153	8mm	1.25P	STANDARD		H207	NT8X125MT	100
12152	8mm	1.25P	FLANGE		H454	NT8X125FN	100
12075	10mm	1.00P	STANDARD		H358	HN358	100
12154	10mm	1.25P	STANDARD	Honda, Toyota	H209	NT10X125MT	100
12162	10mm	1.25P	FLANGE	Honda, Toyota	N/A	N/A	100
12156	10mm	1.50P	STANDARD		H208	NT10X150MT	100
12161	10mm	1.50P	FLANGE		H446	NT10X150FN	100
12159	12mm	1.25P	STANDARD		H356	NT12X125MT	100
12076	12mm	1.50P	STANDARD		H357	HN357	100



BRASS HEXAGON NUTS

ni Number	Size	Thread Type	Style	R.	M.	Quantity
12105	3/8"	Coarse	STANDARD	H315	BRN380C	50
12097	3/8" x 5/8"	Coarse	HIGH STYLE	H524	BRN380X625	10
12317	7/16"	Coarse	STANDARD	H339	BRN716B/C	50
12109	7/16" x 5/8"	Coarse	HIGH STYLE	H567	BRN716X625	10

R. ROL; M. MARWIL

STANDARD MANIFOLD STUDS

ni Number	Size	Thread Type	Application	Description	R.	M.	Qty.
12300	3/8 x 2"	Coarse	GM	W/O FINDERS	H560	MS38200	50
12306	3/8 x 2-1/4"	Coarse	FORD	W/O FINDERS	H191	MS38224	100
12301	3/8 x 2-1/2"	Coarse	GM	W/FINDERS	H561	MS38225	50
12360	3/8 x 2-27/32"	Coarse	GM	W/FINDERS	H528	FMK943	10
12310	3/8 x 3"	Coarse	GM	W/FINDERS	H562	MS38325	50
12307	3/8 x 3-1/4"	Coarse	GM	W/O FINDERS	H211	MS38314	50
12302	3/8 x 3-1/2"	Coarse	CHRYSLER	W/FINDERS	H233	MS38350	50
12311	3/8 x 3-13/16"	Coarse	GM	W/FINDERS	H531	FMK944	10
12312	3/8 x 4"	Coarse	FORD	W/O FINDERS	H429	S429	50
12313	3/8 x 4-13/32"	Coarse	GM	W/FINDERS	H532	FMK945	10
12314	7/16 x 1-5/8"	Coarse	FORD	W/O FINDERS	H213	MS716158	100
12303	7/16 x 2"	Coarse	FORD	W/O FINDERS	H190	S190	100
12349	7/16 x 2-3/8"	Coarse	FORD	W/FINDERS	H563	MS716200	50
12304	7/16 x 2-1/2"	Coarse	FORD	W/O FINDERS	H564	MS716250	50
12315	7/16 x 3"	Coarse	FORD	W/O FINDERS	H569	MS716300	10, 50
12316	7/16 x 3-1/2"	Coarse	FORD	W/O FINDERS	H570	MS716350	10, 50
12305	7/16 x 4 "	Coarse	FORD	W/O FINDERS	H195	MS716400	100

METRIC MANIFOLD STUDS

ni Number	Size	Thread Pitch	Application	Description	R.	M.	Qty.
12353	8mm x 43 mm	1.25P	Nissan / VW	W/O FINDERS	H197	MS8125	100
12356	10mm x 43mm	1.25P	Honda / VW	W/O FINDERS	H210	MS101254	100
12385	10mm x 50mm	1.50P	Pinto/Capri	W/O FINDERS	H212	MS10150	100
12361	10mm x 76mm	1.50P	GM	W/FINDERS	H516	FMK935	10
12318	10mm x 100mm	1.50P	GM	W/FINDERS	H445	FMK916	10
12358	12mm x 50mm	1.25P	Universal	W/O FINDERS	H365	MS12125	50



METRIC SHOULDER BOLTS

ni Number	Size	Thread Pitch	Application	R.	M.	Quantity
12322	8mm x 64.5mm	1.25P	HONDA	H450	FMK920	10
12561	8mm x 75mm	1.25P	CHRYSLER	H444	FMK915	10
12562	10mm x 70mm	1.50P	GM	H443	FMK914	10



R. ROL; M. MARWIL

HEXAGON SELF-TAPPING SCREWS

ni Number	Size	R.	M.	Qty.
12201	5/16 x 1	H170	ST516X100	100
12202	5/16 x 1-1/4	H171	ST516X114	100
12203	5/16 x 1-1/2	H172	ST516X112	100
12204	3/8 x 1	H173	ST380X100	100
12205	3/8 x 1-1/2	H174	ST380X112	100



HEXAGON THREAD CUTTING SCREWS

ni Number	Size	R.	M.	Qty.
12329	5/16 x 1/2	H238	TCS238	100
12171	5/16 x 1	H239	TCS239	100
12330	3/8 x 1	H513	TCS513	25



COTTER PINS

ni Number	Size		R.	M.	Qty.
	Diameter	Length			
12081	3/32"	3/32 X 1-1/4"	H503	CP2X22	100
12501	1/8"	1/8" X 1"	H500	CP18X1	100
12502	1/8"	1/8" X 1-1/2"	H501	CP18X112	100
12503	1/8"	1/8" X 2-1/2"	H502	CP18X212	100
12504	3/16"	3/16 X 2-1/2"	H504	CP316X212	100



SPRING LOCK WASHERS

ni Number	Size	R.	M.	Qty.
12466	1/4"	H175	LW140	100
12461	5/16"	H176	LW516	100
12462	3/8"	H177	LW380	100
12463	7/16"	H178	LW176	100
12080	1/2"	H179	LW120	100



FLAT WASHERS

Number	Size	Hole Size		Class	R.	M.	Qty.
		ID.	OD.				
12400	1/4"	5/16"	3/4"	PLATE (USS)	H180	WA180	100
12402	1/4"	5/16"	1-1/2"	FENDER	N/A	N/A	100
12078	1/4"	9/32"	5/8"	SAE	H214	PW014X625	100
12431	5/16"	3/8"	7/8"	PLATE (USS)	H181	PW516X087	100
12432	5/16"	11/32"	11/16"	SAE	H215	PW516X068	100
12401	5/16"	3/8"	1-1/4"	FENDER	H182	FW516X114	100
12433	3/8"	7/16"	1"	PLATE (USS)	H184	PW380X100	100
12403	3/8"	7/16"	1-1/4"	PLATE (USS)	H568	FW380X114	100
12434	3/8"	13/32"	13/16"	SAE	H216	PW380X081	100
12405	3/8"	7/16"	1-1/2"	FENDER	H183	FW380X112	100
12435	7/16"	1/2"	1-1/4"	PLATE (USS)	H185	PW716X114	100
12436	7/16"	15/32"	15/16"	SAE	H217	PW716X094	100
12077	1/2"	9/16"	1-3/8"	PLATE (USS)	H186	PW012X138	100
12079	1/2"	17/32"	1-1/16"	SAE	H218	WA218	100



O2 SENSOR

ni Number	Thread	Style	Style	R.	M.	Quantity
5512125	12mm X 1.25p	Nut		OSN12x125	OSN12x125	5
5518150	18mm X 1.5p	Nut		OSN18x150	OSN18x150	5, 100
5518150SS	18mm X 1.5p	Nut	Stainless Steel	OSN18x150SS	OSN18x150SS	5
5518150A	18mm X 1.5p	Angle Nut		OSN18x150X45	OSN18x150X45	5
5518150ASS	18mm X 1.5p	Angle Nut	Stainless Steel	N/A	N/A	5
5518150R	18mm X 1.5p	Nut Recessed		OSN18x150R	OSN18x150R	5
5518150RSS	18mm X 1.5p	Nut Recessed	Stainless Steel	N/A	N/A	5
5718150	18mm X 1.5p	Plug		OSP18x150H	OSP18x150H	5, 100

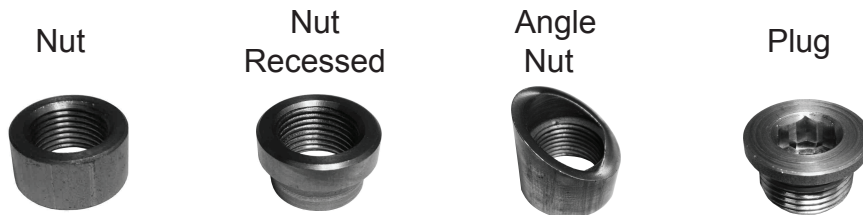

58881

O2 Sensor Flange
Fits Toyota, Chrysler
and Most Imports

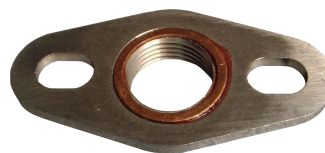

R. ROL; M. MARWIL